

# BURN BOOT CAMP COMING SOON



## ROCKLIN WEST

### NOW OPEN:



### COMING SOON:



**Chris Campbell**  
Executive Vice President  
+1 916 446 8760  
chris.campbell@cbre.com  
Lic. 01204114

**Jason Read**  
Senior Vice President  
+1 916 446 8273  
jason.read@cbre.com  
Lic. 01341972

**Scott Carruth**  
Senior Vice President  
+1 916 446 8717  
scott.carruth@cbre.com  
Lic. 01372285

**AVAILABLE FOR LEASE**

**6815-6851 LONETREE BOULEVARD, ROCKLIN, CA 95765**



# AVAILABILITY FOR LEASE

- ±1,310 SF - (former hair salon)
- ±1,469 SF
- ±1,881 SF
- ±2,302 SF

## PROPERTY HIGHLIGHTS

- ★ Rocklin West is a ±99,478 SF fitness-anchored retail center located in the heart of Placer County's premier retail area at the signalized intersection of Blue Oaks Blvd and Lone Tree Blvd
- 🕒 The Center is within a three mile radius of the Roseville Galleria Mall, The Fountains Shopping Center, Creekside Town Center, and the Ridge at Creekside
- 👥 Attractive mix of experiential, e-commerce resistant tenants. Recently opened Planet Fitness marks the center's first national anchor tenant
- ⛔ Located just off Highway 65 and close to the I-80 interchange making the Center highly accessible to nearby traffic
- 🏠 The project is surrounded by new residential housing stock, office and retail projects

### Exterior Renovations Complete:

- New Monument Signs
- New Awnings
- New Exterior Paint
- New Roof
- New LED Lighting
- Enhanced Landscaping

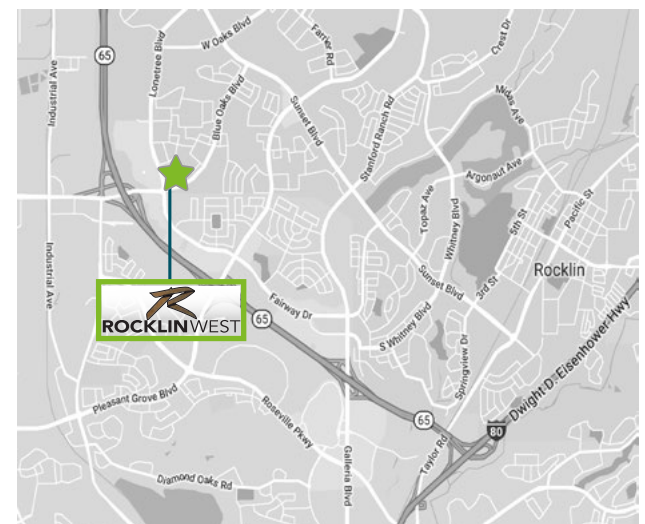
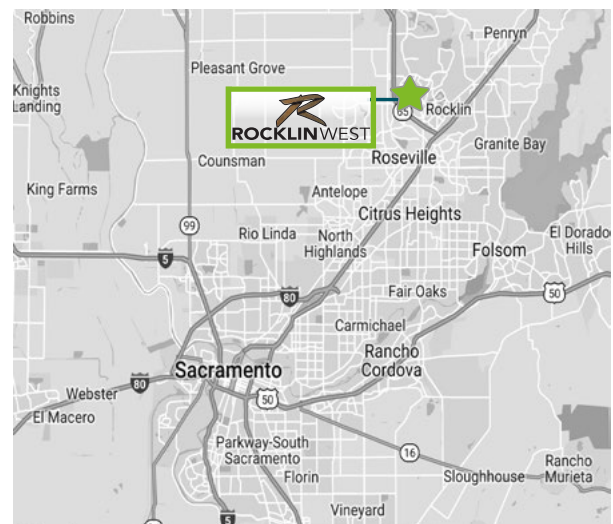

### 2019 TRAFFIC COUNTS

<b>Blue Oaks Blvd.</b>	69,513 ADT
<b>Lonetree Blvd.</b>	18,811 ADT
<b>Highway 65</b>	114,00 ADT
<b>Interstate 80</b>	176,000 ADT

### 2021 ESTIMATED DEMOGRAPHICS

<b>Radius</b>	<b>1-mile</b>	<b>3-mile</b>	<b>5-mile</b>
<b>Population</b>	12,399	104,225	213,751
<b>Avg. Household Income</b>	\$136,483	\$129,794	\$125,381
<b>Daytime Population</b>	13,134	106,014	223,033

# SITE PLAN

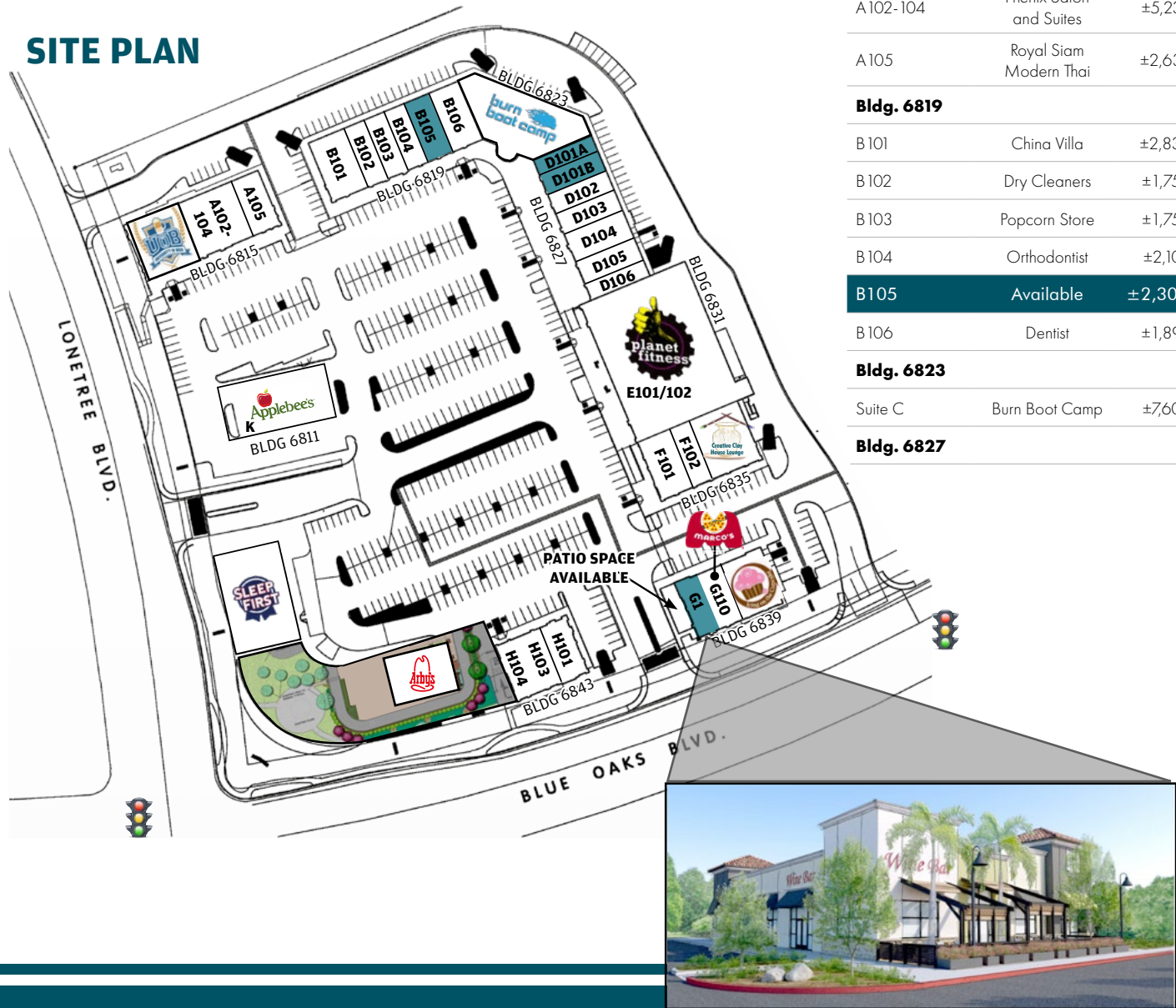

<b>Bldg. 6815</b>		
A 101	University of Beer	±2,635 SF
A 102-104	Phenix Salon and Suites	±5,234 SF
A 105	Royal Siam Modern Thai	±2,635 SF

<b>Bldg. 6819</b>		
B 101	China Villa	±2,836 SF
B 102	Dry Cleaners	±1,756 SF
B 103	Popcorn Store	±1,756 SF
B 104	Orthodontist	±2,108 SF
<b>B 105</b>	<b>Available</b>	<b>±2,302 SF</b>
B 106	Dentist	±1,892 SF

<b>Bldg. 6823</b>		
Suite C	Burn Boot Camp	±7,600 SF

<b>Bldg. 6827</b>		
[Empty]		

D101A	Available	±1,469 SF
<b>D101B</b>	<b>Available</b> (former hair salon)	<b>±1,310 SF</b>
D102	Gold Star Mortgage	±1,405 SF
D103	Ivy Nails	±1,405 SF
D104	Pho Saigon	±2,107SF
D105	ReCreate	±2,810 SF
D106	Flores Munchies	±1,363 SF

<b>Bldg. 6831</b>		
E101 /102	Planet Fitness	±21,139 SF

<b>Bldg. 6835</b>		
F101	Gold Country Running	±2,297 SF
F102	Eaton Physical Therapy	±1,496 SF
F103	Creative Clay	3,793 SF

<b>Bldg. 6839</b>		
G110	Marco's Pizza	1,392 SF
G100	Icing on the Cupcake	±2,992 SF

<b>Pad G1</b>	<b>Available</b>	<b>±1,881 SF</b>
---------------	------------------	------------------

<b>Bldg. 6843</b>		
H 101	First US Bank	±2,701 SF
H 103, 104	Chef's Table	±2,714 SF
Drive Thru Pad I	Arby's	±2,400 SF
Pad J	Sleep First	±4,500 SF

<b>Bldg. 6811</b>		
Pad K	Applebee's	±5,430 SF



Rendering only, subject to tenant build out and approval by city.



## CONTACT US

### Chris Campbell

Executive Vice President

+1 916 446 8760

chris.campbell@cbre.com

Lic. 01204114

### Jason Read

Senior Vice President

+1 916 446 8273

jason.read@cbre.com

Lic. 01341972

### Scott Carruth

Senior Vice President

+1 916 446 8717

scott.carruth@cbre.com

Lic. 01372285

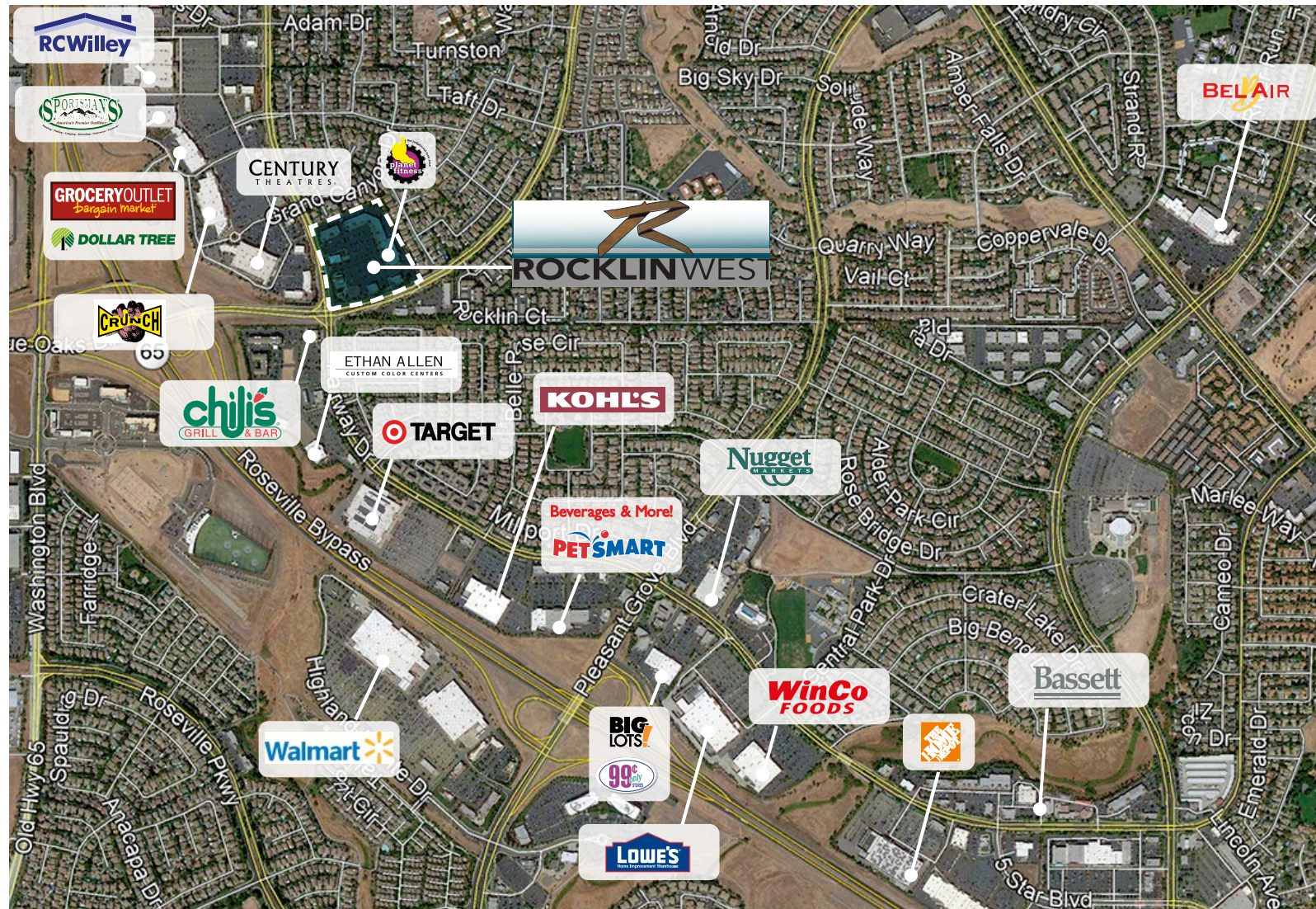

© 2022 CBRE, Inc. All rights reserved. This information has been obtained from sources believed reliable, but has not been verified for accuracy or completeness. Any projections, opinions, or estimates are subject to uncertainty. The information may not represent the current or future performance of the property. You and your advisors should conduct a careful, independent investigation of the property and verify all information. Any reliance on this information is solely at your own risk. CBRE and the CBRE logo are service marks of CBRE, Inc. and/or its affiliated or related companies in the United States and other countries. All other marks displayed on this document are the property of their respective owners. Photos herein are the property of their respective owners and use of these images without the express written consent of the owner is prohibited.